

SCHEDULE OF ADDITIONAL ACCOMMODATION:

- 1: Number of storeys of building. 2 storeys + attic
- 2: Staff accommodation. 2 bedrooms
- 3: Letting rooms with mini bar. 0 rooms
- 4: Letting rooms without mini bar. 0 rooms

LEGEND

- (2600) CEILING HEIGHT
- WINDOW
- FP FIRE PLACE
- DOOR
- TOILET
- URINAL
- WASH HAND BASIN
- BOILER
- FIRE EXIT
- EMERGENCY LIGHT
- DISTRIBUTION BOARD
- SMOKE DETECTOR
- HEAT DETECTOR
- FIRE BLANKET
- FIRE EXTINGUISHER CO₂
- FIRE EXTINGUISHER FOAM
- FIRE EXTINGUISHER WATER
- FIRE EXTINGUISHER POWDER
- SPRINKLER OUTLETS
- DRY RISER
- WET RISER
- FIRE ALARM CALL POINT
- STEPS
- SINK UNIT
- AMUSEMENT WITH PRIZES
- BAR FLAP

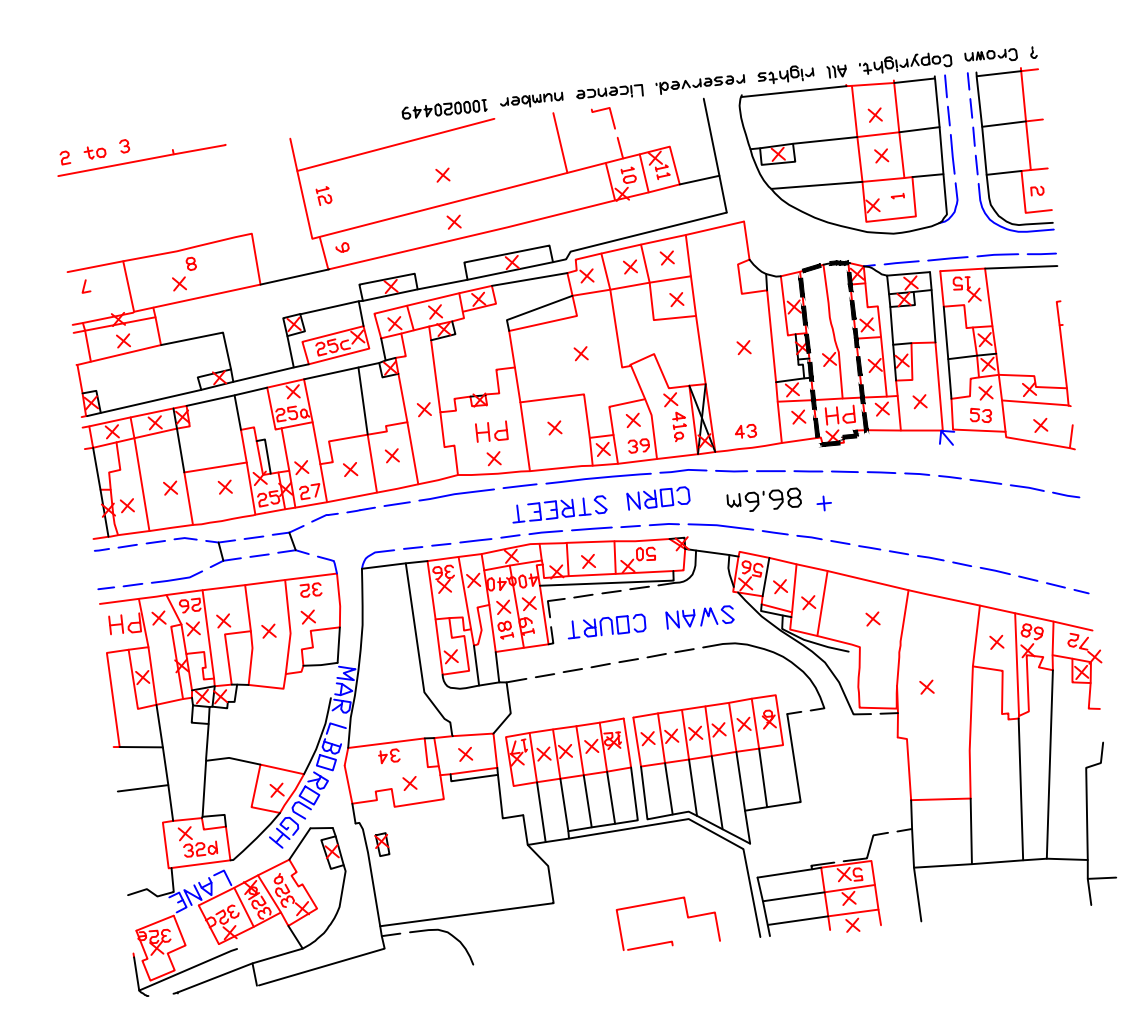
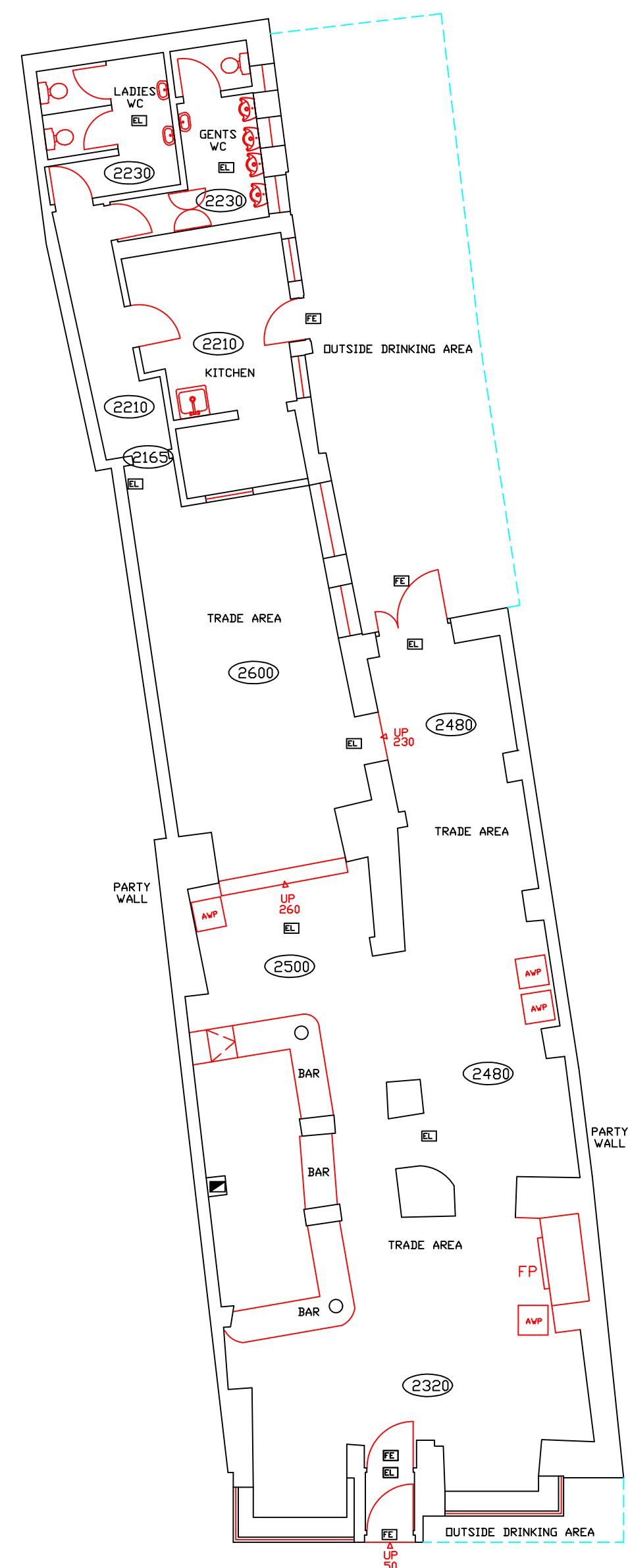

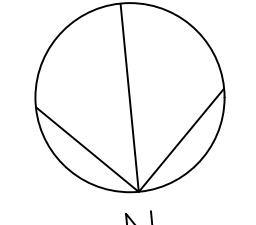
 N
 INDICATIVE ONLY
 SCALE 1:1250

BUILDING SURVEYED AREA = 198.5 SQ. M
 ■ LOCATED ON FIRST FLOOR

SCALE 1:100
 GROUND FLOOR

PROPERTY INFORMATION		LICENSING SURVEY PLAN	
Property ID	Property Name	Date of Survey	Drg. Scale
900388	Chequers Inn	04/10/04	AS SHOWN
Address		LICENSING SURVEY PLAN	
47 Corn Street		Date of Survey	
Witney		Drg. Scale	
Oxon		AS SHOWN	
OX8 6NZ		LICENSING SURVEY PLAN	
REV.		DATE	
1 KITCHEN AREA AMENDMENTS		04/10/04	
2			
3			
4			