

These are the notes referred to on the following official copy

The electronic official copy of the title plan follows this message.

Please note that this is the only official copy we will issue. We will not issue a paper official copy.

This official copy was delivered electronically and when printed will not be to scale. You can obtain a paper official copy by ordering one from Land Registry.

Additional references, which are not referred to in the register of title, may appear on the title plan in respect of any pending applications.

This official copy is issued on 22 March 2012 shows the state of this title plan on 22 March 2012 at 10:12:53. It is admissible in evidence to the same extent as the original (s.67 Land Registration Act 2002). This title plan shows the general position, not the exact line, of the boundaries. It may be subject to distortions in scale. Measurements scaled from this plan may not match measurements between the same points on the ground. See Land Registry Public Guide 7 - *Title Plans*.

This title is dealt with by the Land Registry, Birkenhead Office .

© Crown copyright. Produced by Land Registry. Reproduction in whole or in part is prohibited without the prior written permission of Ordnance Survey. Licence Number 100026316.

H. M. LAND REGISTRY

ESSEX SHEET LXX 14

Scale 1/1250
Enlarged from 1/2500

BOROUGH OF HAVERING

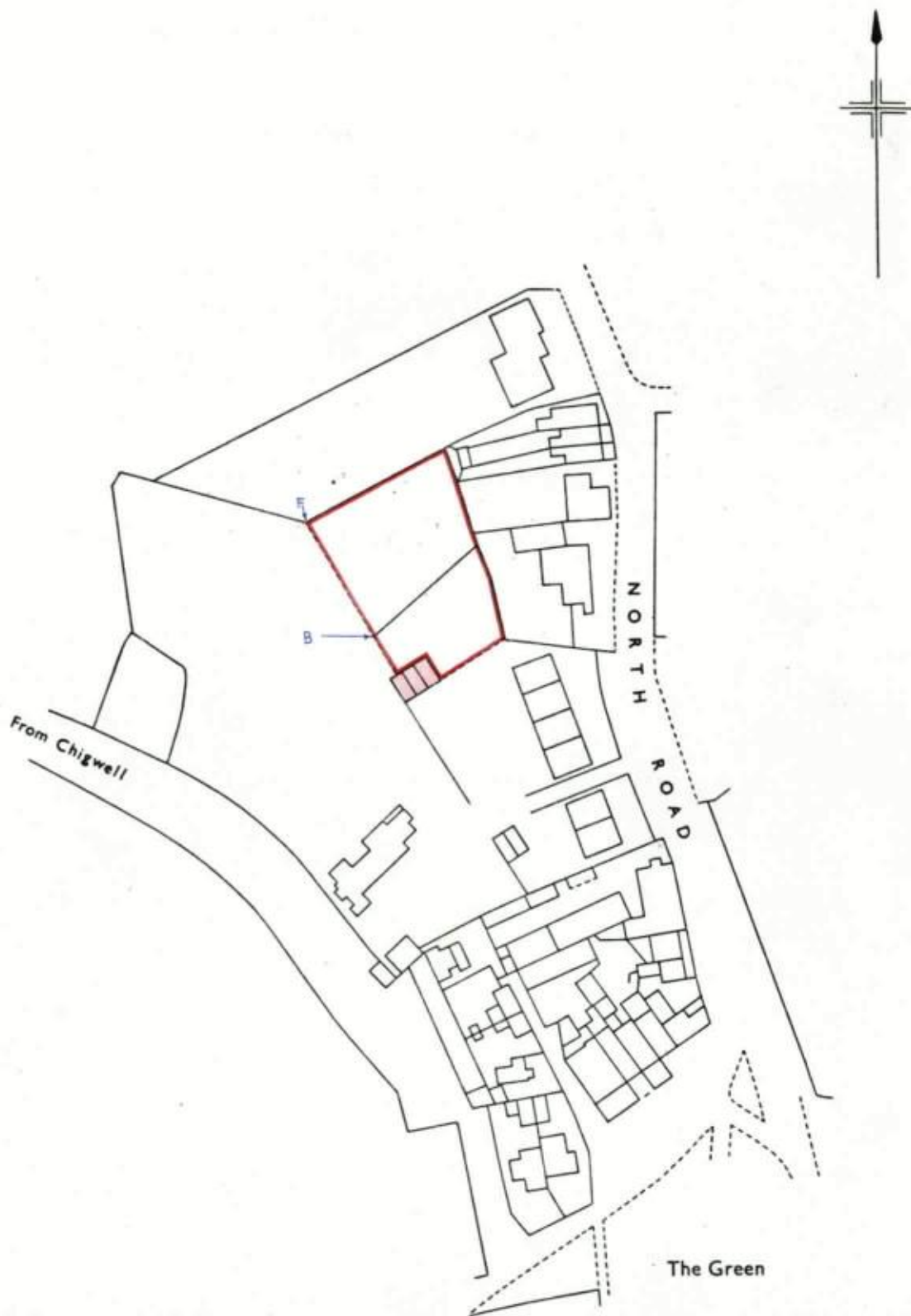

Made and printed by the Director
General of the Ordnance Survey,
Chessington, Surrey. 1965 for HMLR
© Crown Copyright 1965

Filed Plan of Title No. **EX 97659**